

BCA

Single Point Load Cell, 5kgf-100kgf

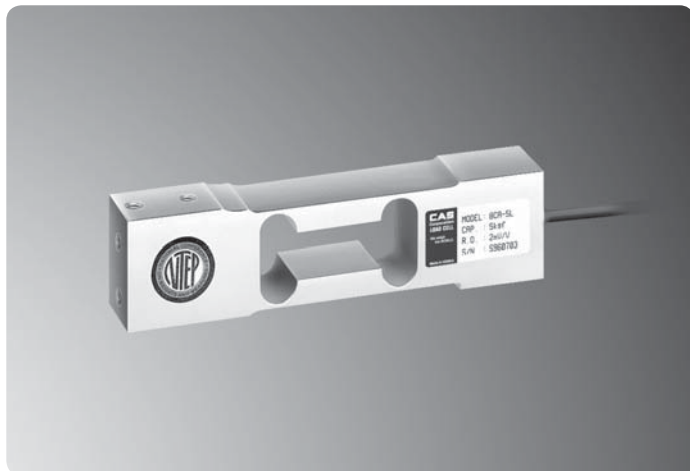

LOAD CELL



DIMENSION

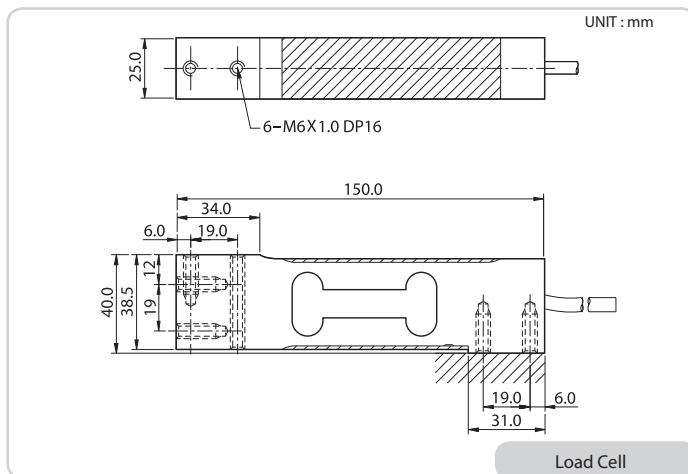

FEATURES

- OIML C3 Approved (OIML R60)
- NTEP III 5,000 approved (A5)
- 6-wires connection
- Protection Class IP65

SPECIFICATION

Max. Capacity (Rated Load)	kgf	5, 10, 15, 20, 30, 50, 75, 100	
Rated Output	mV / V	2.0 ± 0.2	
Zero Balance	mV / V	0.0 ± 0.1	
Accuracy Class	-	D3	C3
Non-Linearity	% R.O.	0.03	0.02
Hysteresis	% R.O.	0.03	0.02
Combined Error	% R.O.	0.03	0.02
Repeatability	% R.O.	0.01	0.01
Creep for 30min.	% R.O.	0.03	0.017
Return for 30min.	% R.O.	0.03	0.017
Resolution	-	≤ 1/3000	≤ 1/5000
Division	mV / V	0.00067	0.0004
Temperature Effect on	-	-	-
Zero Value	% / 10	0.028	0.014
Output Value	% / 10	0.014	0.011
Excitation	-	-	
Recommended	V	10	
Maximum	V	15	
Resistance	-	-	
Input	Ω	400 ± 20	
Output	Ω	350 ± 3.5	
Insulation	M Ω	>2000	
Compensated Temperature Range		-10 to +40	
Operating Temperature Range		-20 to +70	
Material & Plate	-	Anodized Aluminum	
Cable Specification	-	ø5 x 4p x 1M (Urethane)	
Safety Overload	% R.L.	150	
Platform Size	mm	400 x 400	