



Pan Cake - Load Cell 2t / 3t / 5t / 10t / 20t



- Hermetically sealed
- High reliability against fatigue and side force
- High accuracy grade
- Option : Ex ia IIC T6 Approved



Technical Specifications

Max Capacity (rated load)	kgf	2t, 3t, 5t, 10t, 20t
Rated Output	mV / V	2.0 ± 0.005
Zero Balance	mV / V	0.0 ± 0.20
Accuracy Class	-	C3
Combined Error	% R.O.	0.02
Repeatability	% R.O.	0.01
Creep for 30min.	% R.O.	0.03
Resolution	-	≤1/5000
Division	mV/V	0.0004
Temperature Effect on - Zero Value	%/10 °C	0.03
Temperature Effect on - Output Value	%/10 °C	0.03
Excitation - Recommended	V	10
Excitation - Maximum	V	15
Resistance - Input	Ω	350 ± 3.5
Resistance - Output	Ω	350 ± 3.5
Resistance - Insulation	MΩ	> 2000
Compensated Temperature Range	°C	-10 to +40
Operating Temperature Range	°C	-30 to +80
Safety Overload	% R.L	150%
Cable Specification	-	ø8 x 4p x 5M(10M)

Dimension

Unit in mm

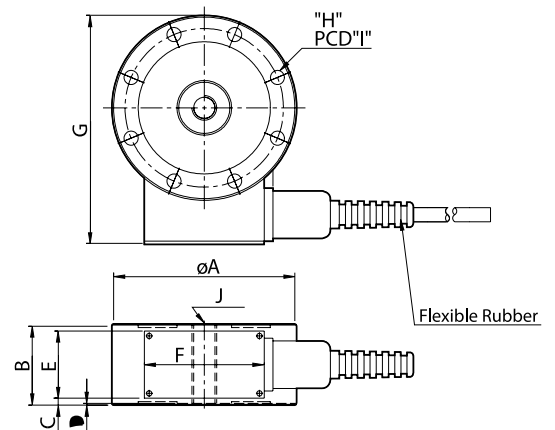

Capacity	A	B	C	D	E	F	G	H	I	J	Cable
2t	112.0	46.0	4.0				141.5	8-ø7.1	97.2	M16 X 2.0	5.0
3t											
5t	120.0	46.0	4.0	1.0	38.0	68.0	149.9	8-ø9.0	103.2	M18 X 1.5	
10t	138.0	60.0	11.0				169.5	8-ø11	117.6	M24 X 2.0	10.0
20t	184.0	80.0	21.0				218	8-ø14	157.6	M39 X 2.0	

Options

- Accessory for compression
- Accessory for tension
- Ball type accessory



UNIT 8, NORTHLINK, 459 TUFNELL ROAD
BANYO QLD 4014, AUSTRALIA

TEL: +61 (0)7 3267 7767 FAX: +61 (0)7 32 67 1818

EMAIL: sales@cassscale.com.au

<http://www.cassscale.com.au>

Specifications are subject to change for improvement without prior notice.

